

# Product Guide



**DICKE Safety Products**

**TwinFlex™**

Spring Stands for Roll-Up and Rigid Signs



TwinFlex™ Spring System

- NCHRP-350 approved.
- Dual heavy duty steel coil springs.
- Hold 36" and 48" signs in a variety of materials and configurations.
- Models to meet all sign height requirements.
- Easy to use with kick release system for legs and quick locking sign holders.
- Aluminum and steel construction.

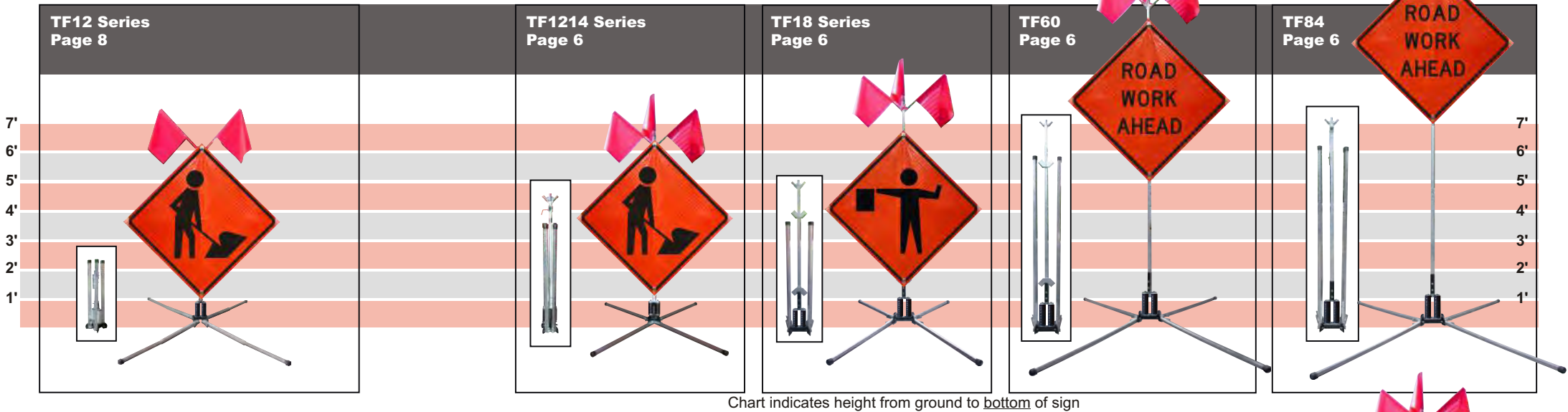

**DynaFlex™**

Spring Stands for Roll-Up Signs



DynaFlex™ Spring System

- NCHRP-350 approved.
- Dual torsion springs.
- Hold 36" and 48" signs in a variety of materials and configurations.
- Models to meet all sign height requirements.
- Easy to use with kick release system for legs and quick locking sign holders.
- Aluminum and steel construction.

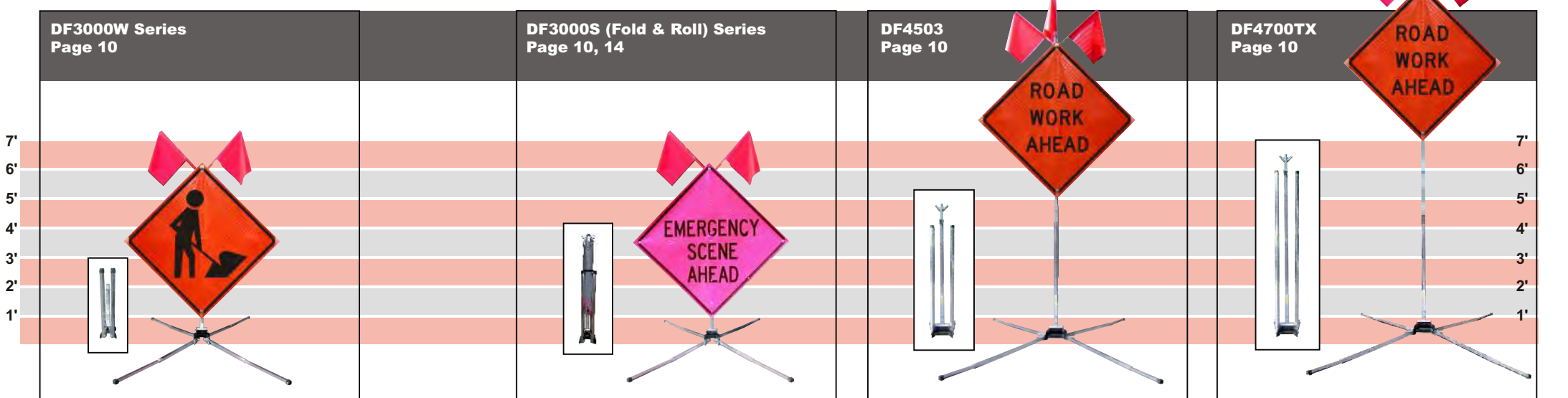

**UniFlex™**

Spring Stands for Roll-Up Signs



UniFlex™ Spring System

- NCHRP-350 approved.
- Hold 36" and 48" signs in a variety of materials and configurations.
- UF2000W has a single upright coil spring.
- UF2000W and DL1000W stands feature kick releases and Screwlock™ sign holder.
- Economical tripods hold 36" and 48" rigid and roll-up signs.

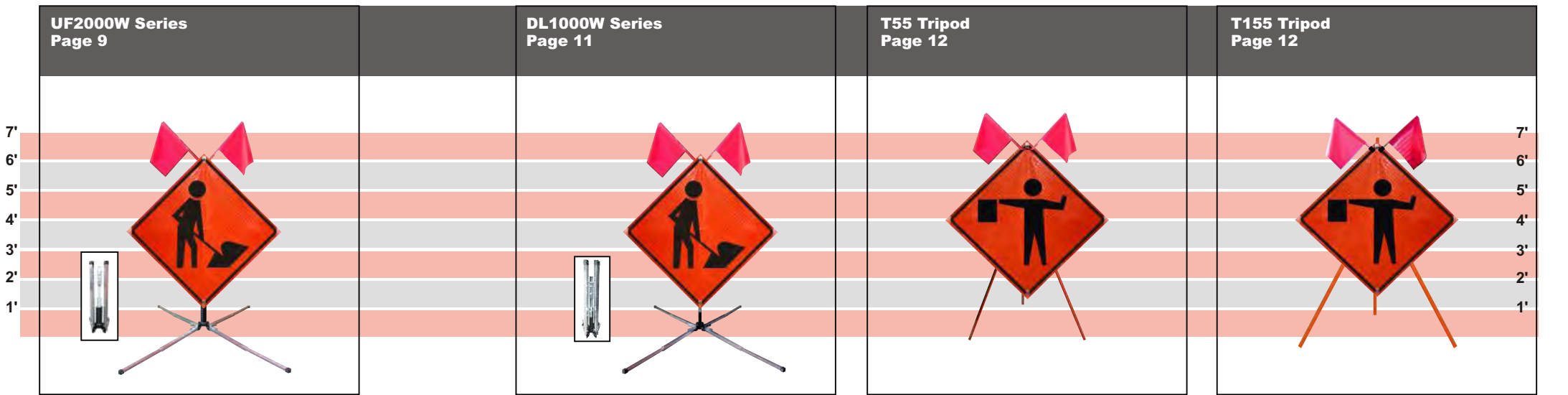

## TwinFlex™

### Spring Stands for Roll-Up and Rigid Signs



TwinFlex™ Spring System

- NCHRP-350 approved.
- Dual heavy duty steel coil springs.
- Hold 36" and 48" signs in a variety of materials and configurations.
- Models to meet all sign height requirements.
- Easy to use with kick release system for legs and quick locking sign holders.
- Aluminum and steel construction.

## TF12 Series Page 8

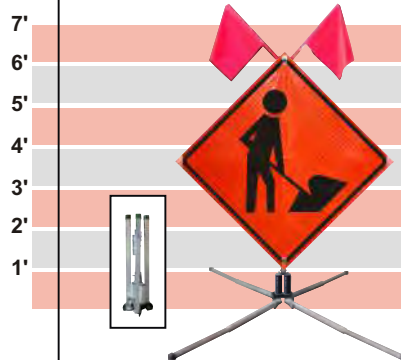

## DynaFlex™

### Spring Stands for Roll-Up Signs



DynaFlex™ Spring System

- NCHRP-350 approved.
- Dual torsion springs.
- Hold 36" and 48" signs in a variety of materials and configurations.
- Models to meet all sign height requirements.
- Easy to use with kick release system for legs and quick locking sign holders.
- Aluminum and steel construction.

## DF3000W Series Page 10

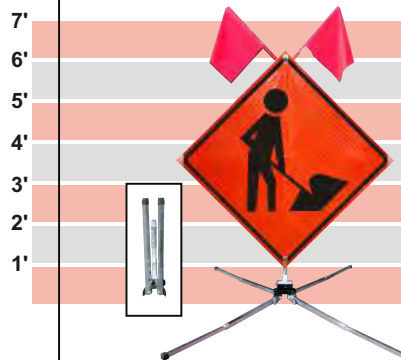

## UniFlex™

### Spring Stands for Roll-Up Signs



UniFlex™ Spring System

- NCHRP-350 approved.
- Hold 36" and 48" signs in a variety of materials and configurations.
- UF2000W has a single upright coil spring.
- UF2000W and DL1000W stands feature kick releases and Screwlock™ sign holder.
- Economical tripods hold 36" and 48" rigid and roll-up signs.

## UF2000W Series Page 9

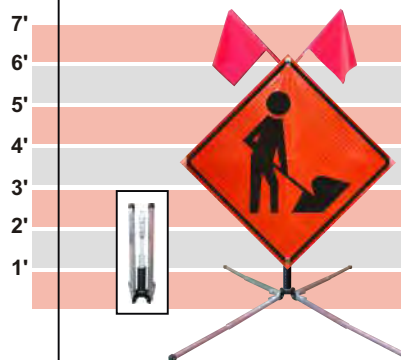

Sign Stands

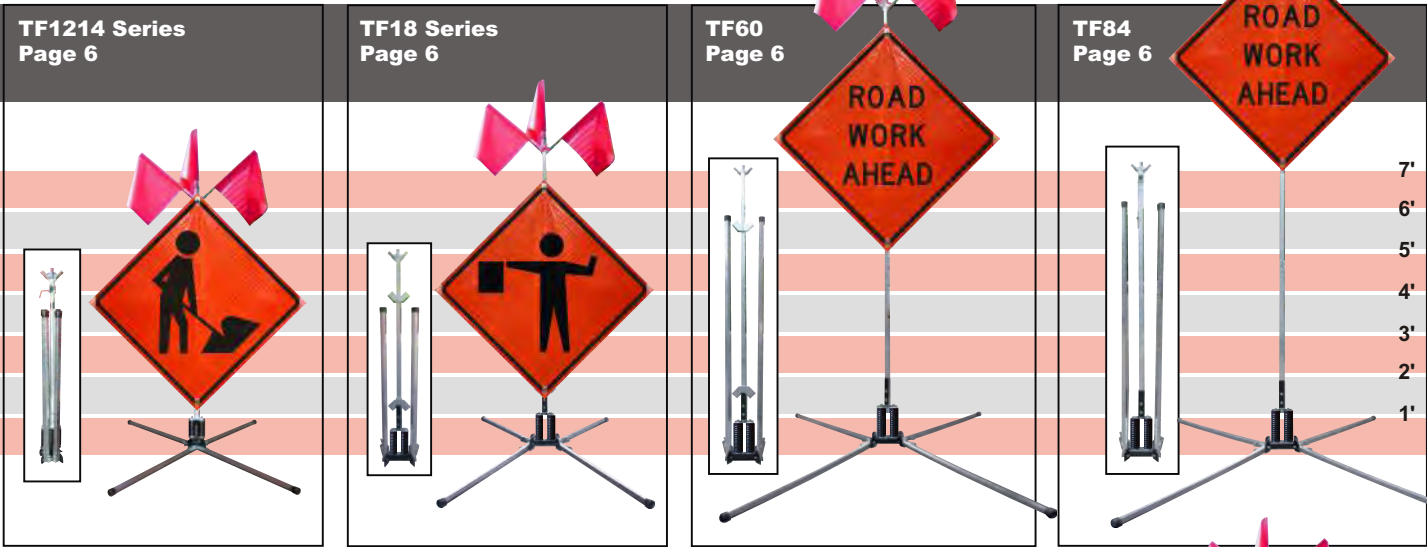
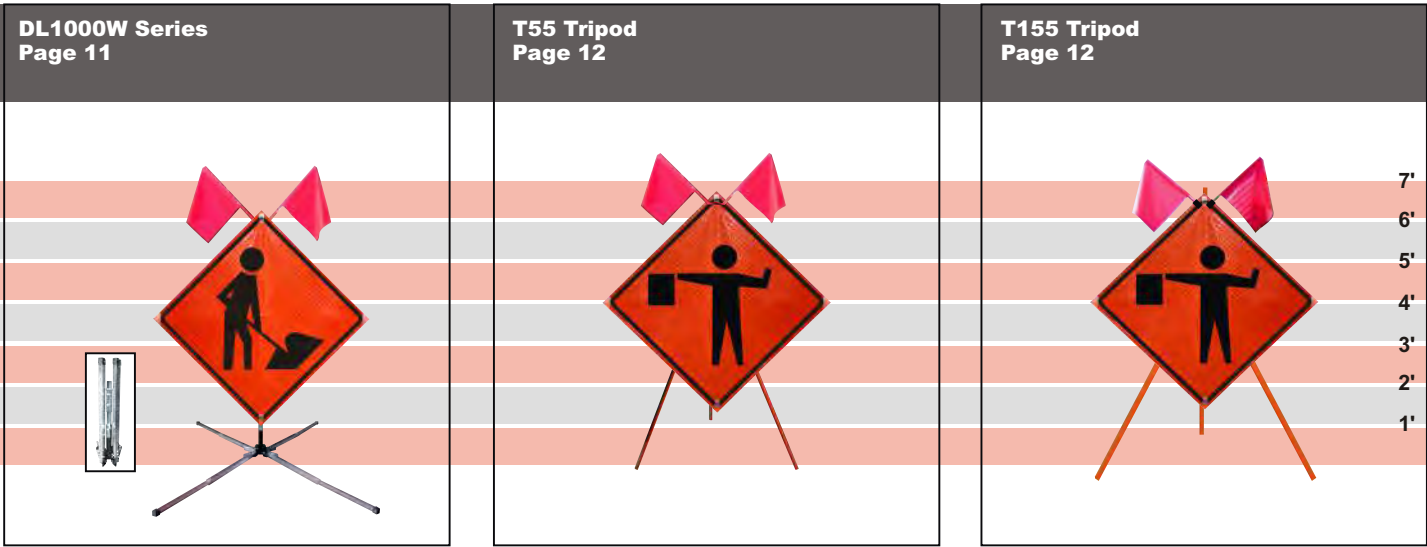
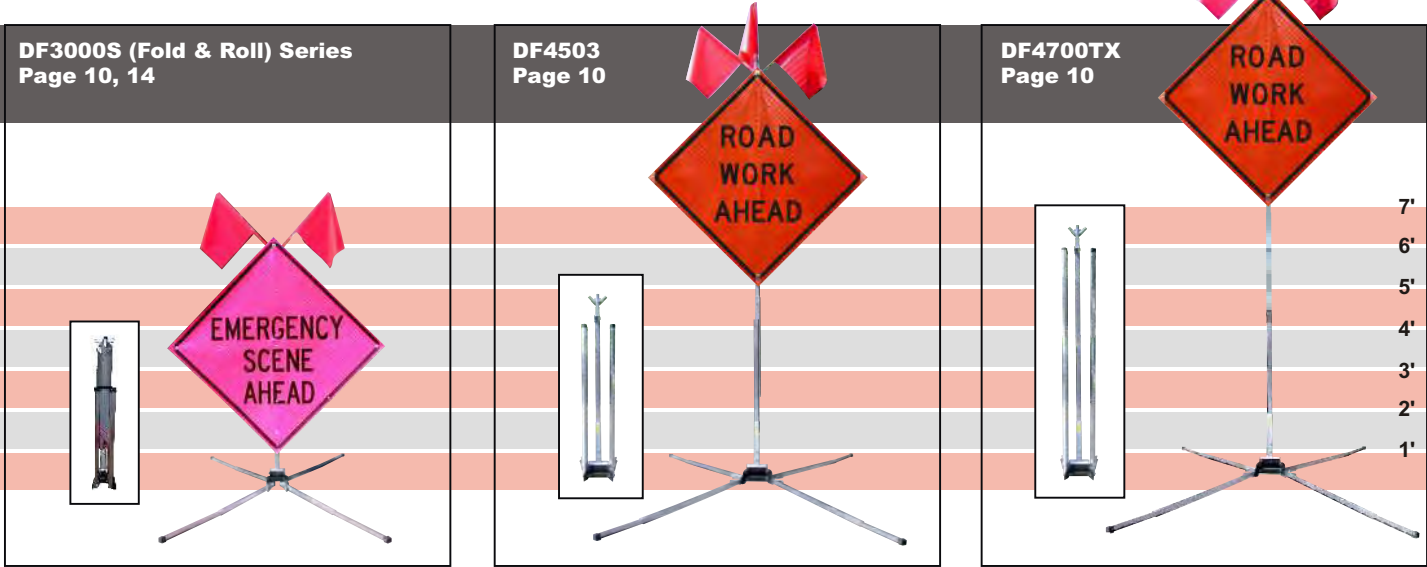

Chart indicates height from ground to bottom of sign



## Sign Holders

**Roll-Up Sign Holders** - Dicke Safety Products offers several different methods of mounting roll-up signs to sign stands, all are made from zinc plated steel and/or aircraft quality aluminum. All sign holders have been designed with durability and ease of use in mind.



Our most universal roll-up sign holder will accept all standard 1-1/4" width fiberglass cross braces. Internal lever actuated clamp grips firmly and quickly and prevents damage from over tightening.



Stablock sign holder is used to hold our popular Fold & Roll™ Sign Panel. Vertical aluminum tubing slides down over small diameter base fitting. Locks in place with a spring button. This option provides the fastest set-up and most compact storage dimensions available.

The RUB3315 roll-up bracket holds all 36" and 48" roll-up signs with horizontal fiberglass ribs up to 1/4" thick. Used with stands that incorporate an aluminum two or three piece mast design. Roll-up bracket also allows for a quick switch from rigid signs to roll-up signs. Used with Dicke's RUNR and RUR series signs with fiberglass rib supports.



Clamps the roll-up sign to the stand utilizing bottom rectangular plastic pocket on roll-up sign panel. Spring loaded catch automatically locks sign into base, a lift of the lever releases to sign.



The channel style panel holder locks the roll-up sign to the stand with a lever actuated pin. The roll-up sign's vertical fiberglass rib, with pre-drilled locking hole, slides down into channel opening and engages a locking pin. Used with Dicke roll-up signs attached to 400 series ribs.

Sign Stand Index								
Model No.	Page	Sign Types				Stand Specifications		
		Roll-Up Signs	Rigid Signs	Fold & Roll Signs	Minimum Sign Display Height	Storage Size	Open Footprint	Weight (lbs)
DF3000S	14			●	12"	7.5" x 7.5" x 24"	45" x 71"	17
DF3000W	10	●			12"	7.5" x 7.5" x 24"	45" x 71"	21
DF3003S	14			●	12"	7.5" x 7.5" x 30"	56" x 92"	19
DF3003W	10	●			12"	7.5" x 7.5" x 30"	56" x 92"	22
DF4503	10	●			5'	9.5" x 9" x 60"	72" x 117"	37
DF4700TX	10	●			7'	9.5" x 9.5" x 79"	82" x 128"	42
DL1000L	11	●			12"	7" x 7" x 24"	42" x 71"	13
DL1000W	11	●			12"	7" x 7" x 24"	42" x 71"	15
DL1003L	11	●			12"	7" x 7" x 30"	53" x 93"	14
DL1003W	11	●			12"	7" x 7" x 30"	53" x 93"	17
DL1008-RUB	11	●			18"	7" x 7" x 64"	46" x 78"	17
DSB100	13	●			12"	3" x 20" x 28"	20" x 28"	42
DSB100HD	13	●			12"	3" x 20" x 28"	20" x 28"	48
DSB100HD-W	13	●			12"	3" x 20" x 28"	20" x 28"	49
DSB100-W	13	●			12"	3" x 20" x 28"	20" x 28"	43
SDL1000L	11	●			12"	7" x 7" x 24"	41" x 69"	19
SDL1000W	11	●			12"	7" x 7" x 24"	41" x 69"	20
SDL1008-RUB	11	●			18"	7" x 7" x 64"	47" x 77"	25
STF12C	8	●			12"	7" x 7" x 24"	48" x 66"	28
STF12W	8	●			12"	7" x 7" x 24"	48" x 66"	29
STF1008-RUB	6	●			18"	7" x 7" x 84"	52" x 74"	38
STF1214-RUB	6	●			18"	7" x 7" x 51"	52" x 74"	33
STF18-RGB	6		●		18"	8" x 8" x 64"	36" x 84"	40
STF18-RUB	6	●			18"	8" x 8" x 64"	36" x 84"	40
STF18RG/RU	6	●	●		18"	8" x 8" x 64"	36" x 84"	41
SUF2000S	9			●	12"	7" x 7" x 24"	42" x 69"	23
SUF2000W	9	●			12"	7" x 7" x 27"	42" x 69"	25
T155	12	●	●		18"	4.5" x 8" x 55"	48" x 57"	16
T55	12	●	●		18"	2" x 4.5" x 62"	48" x 57"	10
TF1214-RUB	6	●			18"	7" x 7" x 51"	52" x 73"	28
TF12C	8	●			12"	7" x 7" x 30"	62" x 87"	24
TF12W	8	●			12"	12" x 12" x 30"	62" x 87"	26
TF18-RG/RU	6	●	●		18"	8" x 8" x 64"	36" x 84"	33
TF18-RGB	6		●		18"	8" x 8" x 64"	36" x 84"	32
TF18-RUB	6	●	●		18"	8" x 8" x 64"	36" x 84"	32
TF60-RG/RU	6	●	●		5'	12" x 12" x 68.5"	75" x 134"	49
TF60-RGB	6		●		5'	12" x 12" x 68.5"	75" x 134"	48
TF60-RUB	6	●			5'	12" x 12" x 68.5"	75" x 134"	48
TF84-RG/RU	6	●	●		7'	12" x 12" x 78.5"	75" x 134"	50
TF84-RGB	6		●		7'	12" x 12" x 78.5"	75" x 134"	49
TF84-RUB	6	●			7'	12" x 12" x 78.5"	75" x 134"	49
UF2000S	9			●	7'	7" x 7" x 30"	56" x 92"	20
UF2000W	9	●			12"	7" x 7" x 30"	56" x 92"	22

## TwinFlex™ Full Size Sign Stands

TwinFlex™ full size signs stands feature steel and aluminum construction for long-lasting, dependable service. Dual heavy duty steel coil springs provide stability in gusty wind conditions.

TwinFlex™ stands are available in several models that are designed to display roll-up and rigid signs at a mounting height of 14" to 7'. All stands feature foot-actuated leg releases with two locking positions for stability on uneven terrain.

- MUTCD and NCHRP-350 compliant.
- TwinFlex™ features a two stage telescopic aluminum mast which allows roll-up and/or rigid signs to be displayed 14" to 84" off the ground (depending on model selected, see chart below).
- Triple flagholder for 3/4" round flag staffs factory installed.
- Foot operated leg releases quickly lock legs in one of three positions to allow for storage or deployment on uneven terrain.
- Aluminum leg models feature .100" wall aircraft quality tubing, 16 ga. steel leg models have an orange powder coat finish.

Model Number	Sign Height*	Roll-Up Signs	Rigid Signs	Legs
STF1008-RUB	5' or 7'	●		Steel
STF1214-RUB	14"	●		Steel
STF18-RUB	18"	●		Steel
STF18-RGB	18"		●	Steel
STF18-RG/RU	18"	●	●	Steel
TF1214-RUB	14"	●		Aluminum
TF18-RUB	18"	●		Aluminum
TF18-RGB	18"		●	Aluminum
TF18-RG/RU	18"	●	●	Aluminum
TF60-RUB	5'	●		Aluminum
TF60-RGB	5'		●	Aluminum
TF60-RG/RU	5'	●	●	Aluminum
TF84-RUB	7'	●		Aluminum
TF84-RGB	7'		●	Aluminum
TF84-RG/RU	7'	●	●	Aluminum

\*Ground to bottom of 48" sign

**TwinFlex™**  
Full Size Features



TF18 RGB

• Triple Flagholder

• New Style Rigid Bracket (optional)

• Telescopic Mast

• Roll Up Sign Bracket (optional)

• New Style Rigid Sign Bracket (optional)

• Dual Heavy Duty Springs

• Non Skid Tips

• Foot Operated Leg Release

• Aluminum or Steel Legs Available  
(See chart on page 6)



STF18 RGB

## TwinFlex™

### Compact Stands for Roll-Up Signs

Model Number	Sign Height*	Roll-Up Sign Holder Type	Legs
STF12W	12"	Screwlock	Steel
STF12C	12"	Channel	Steel
TF12W	12"	Screwlock	Aluminum
TF12C	12"	Channel	Aluminum

\*Ground to bottom of 48" sign



The TF12C features the Channel Style sign holder for roll up signs with 3/8" vertical ribs.

TwinFlex™ compact stands feature steel and aluminum construction for long-lasting, dependable service. Dual heavy duty steel coil springs provide stability in gusty wind conditions.

The TF12 series compact stands are available in several models designed to display roll-up signs at a mounting height of 12". All stands feature foot-actuated leg releases with adjustable locking positions for stability on uneven terrain.

- MUTCD and NCHRP-350 compliant.
- TwinFlex™ compact stands offer two methods of roll-up sign attachment: Screwlock or Channel style. See pg.4 for details.
- Aluminum leg models feature .100" wall aircraft quality tubing, economical 16 ga. steel leg models have an orange powder coat finish.
- Steel leg length is 22" that telescopes to 38". Aluminum leg version is 30" and telescopes to 51".

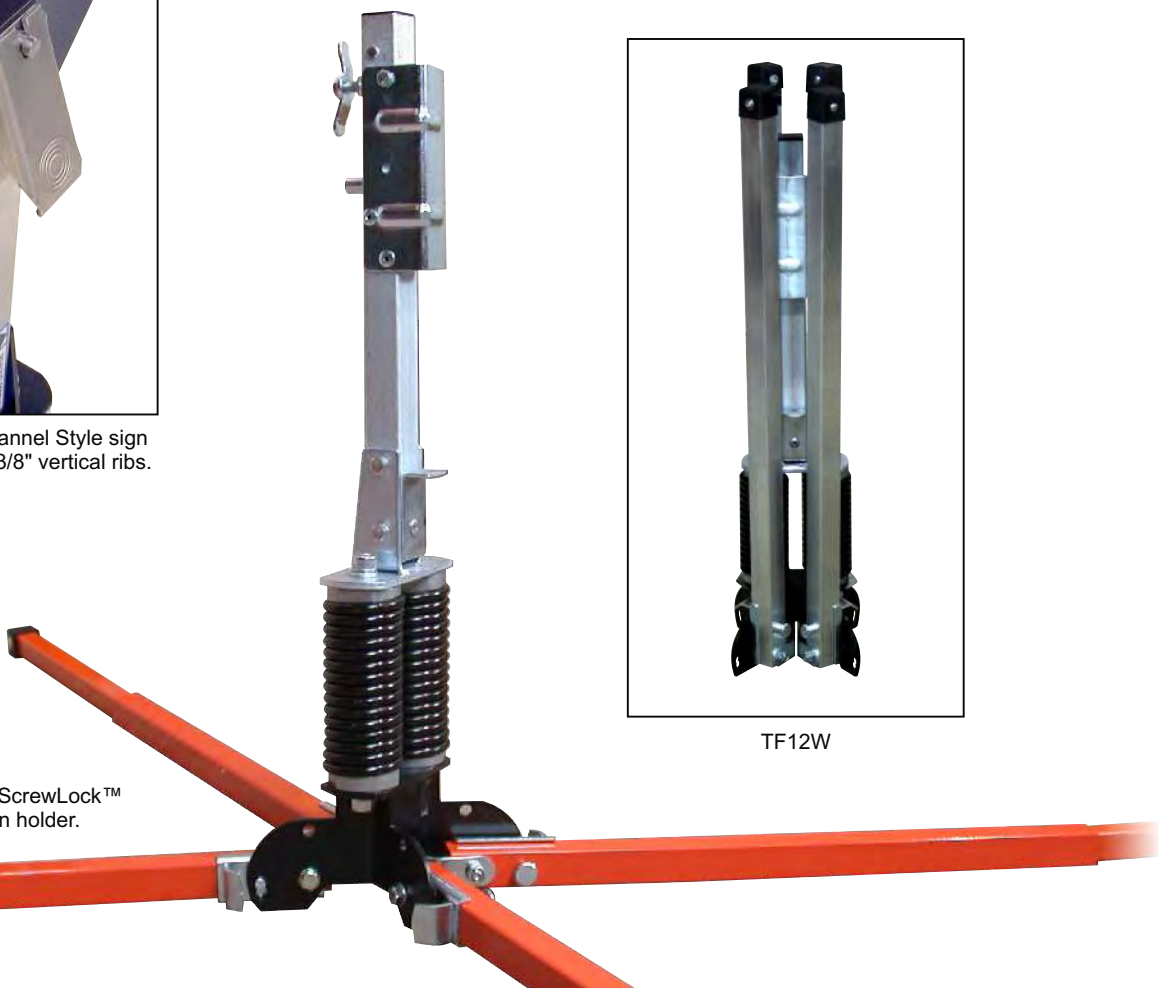

STF12W with ScrewLock™ roll up sign holder.

TF12W

# UniFlex™

## Single Spring Stand for Roll-Up Signs

UniFlex™, our most popular compact stand, is the perfect match for 36" and 48" roll-up signs. UniFlex™ features a heavy duty steel coil spring design providing superior stability in windy conditions.

UniFlex™ stands display roll-up signs 12" off the ground and feature foot actuated kick releases with three locking positions for storage and stability on uneven terrain.

- MUTCD and NCHRP-350 compliant.
- UniFlex™ compact stands offer two methods of roll-up signs attachment: Screwlock for standard roll-up signs or Stablock™ for Fold & Roll™ signs, see pg.4 for details.
- Single heavy duty steel spring provides stability in gusty winds.
- Aluminum leg models feature .100" wall aircraft quality tubing, economical 16 ga. steel leg models have an orange powder coat finish.
- Steel leg length is 22" that telescopes to 38". Aluminum leg version is 30" and telescopes to 51".

Model Number	Sign Height*	Roll-Up Sign Holder Type	Legs
UF2000W	12"	Screwlock	Aluminum
UF2000S	12"	Stablock	Aluminum
SUF2000W	12"	Screwlock	Steel
SUF2000S	12"	Stablock™	Steel

\*Ground to bottom of 48" sign



UniFlex™ spring flexes to provide stability in windy conditions.





Stablock™ panel holder  
option for Fold & Roll™  
See pages 14 and 15

- Dual Torsion Spring System

- Original Kick Release

Model Number	Sign Height*	Roll-Up Sign Holder Type	Sign Type
DF3000W	12"	Screwlock	Roll-Up
DF3003W	12"	Screwlock	Roll-Up
DF3000S	12"	Stablock	Fold & Roll™
DF3003S	12"	Stablock	Fold & Roll™
DF4503	5'	RUB3315	Roll-Up
DF4700TX	7'	RUB3315	Roll-Up

\*Ground to bottom of 48" sign



DynaFlex™ compact stands feature steel and aluminum construction for durability and a long service life. Dual heavy duty torsion springs provide stability in gusty wind conditions.

The DynaFlex™ series of compact stands display either standard roll-up signs or our popular Fold and Roll™ signs (see page 14) 12" off the ground. Full size DynaFlex™ stands display roll-up signs at a mounting height of 5' to 7' (see chart above) and feature a two stage aluminum mast and RUB3315 sign attachment.

- All DynaFlex™ stands are MUTCD and NCHRP-350 compliant.
- DynaFlex™ compact stands offer two methods of roll-up sign attachment: Screwlock for standard roll-up signs or Stablock for Fold & Roll™ signs, see page 4 for details.
- Heavy duty steel torsion spring system provides a smooth, gliding reaction to wind gusts - no whipping action.
- Compact stands available in two leg lengths. DF3000 series stands have 22" legs that telescope to 38". DF3003 series stands offer 30" leg length that telescopes to 51".

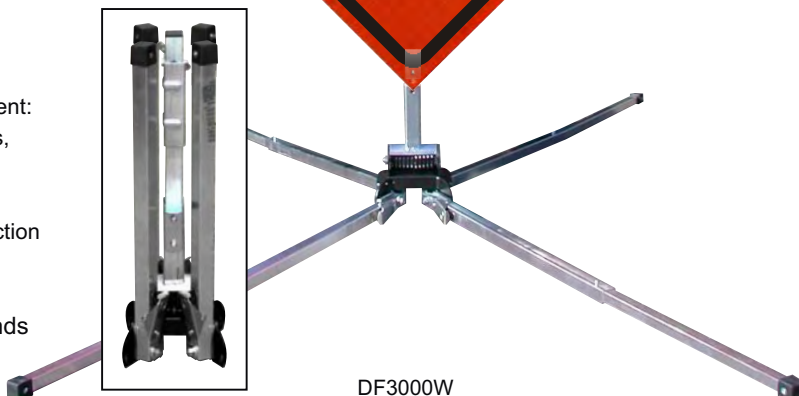

Our DynaLite™ series offers non-spring, lightweight, compact stands designed to display 36" or 48" roll-up signs. Made of powder coated steel and aircraft quality aluminum, these stands are rugged and dependable.

- MUTCD and NCHRP-350 compliant.
- DynaLite™ compact stands offer two methods of roll-up sign attachment: Screwlock™, which quickly and firmly clamps to the vertical fiberglass rib, or the Latch style sign holder which holds the sign by bottom plastic pocket. See pg. 4 for details.
- Dynalite™ full size stands feature telescopic vertical masts and triple flag-holders designed to display 36" or 48" roll-up signs.
- Foot operated leg releases quickly lock legs in one of three positions to allow for storage or deployment on uneven terrain.
- SDL1000 and DL1000 series stands have steel or aluminum 22" legs that telescope to 38". DL1003 series stands offer 30" leg length that telescopes to 51". SDL1008 and DL1008 stands come in 42" leg length.

• Triple Flag Holder

• Roll Up Sign Bracket

• Non skid rubber tips

• Foot actuated leg releases

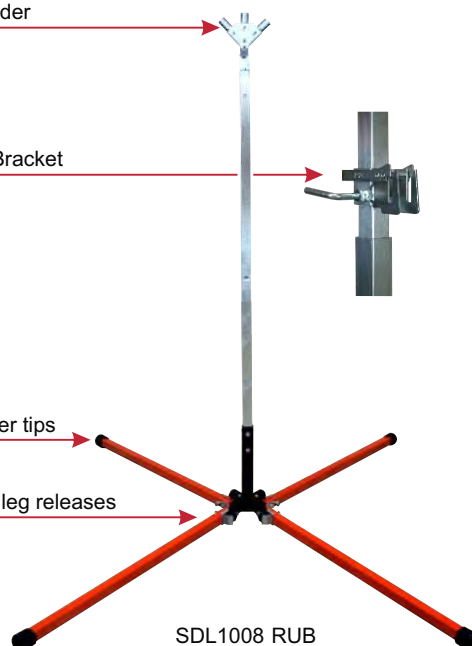

SDL1008 RUB



DL1000W

Model Number	Sign Height*	Roll-Up Sign Holder Type	Legs
DL1000W	12"	Screwlock	Aluminum
DL1003W	12"	Screwlock	Aluminum
SDL1000W	12"	Screwlock	Steel
DL1000L	12"	Latch	Aluminum
DL1003L	12"	Latch	Aluminum
SDL1000L	12"	Latch	Steel
DL1008-RUB	Variable	Roll-Up Bracket	Aluminum
SDL1008-RUB	Variable	Roll-Up Bracket	Steel

\*Ground to bottom of 48" sign



SDL1000W



### T55 Tripod

*For Roll-Up Signs*

The T55 tripod is an all-purpose three legged economy sign stand designed to hold 36" and 48" roll-up and rigid signs. Powder coated steel construction and ease of use makes the T55 a smart choice for low to medium wind conditions.

- Meets MUTCD specifications, NCHRP-350 compliant.
- Compact storage, economical, and easy to use.
- Holds 36" and 48" roll-up and rigid signs.
- Powder coated, all steel construction.



T55 with 48" roll up sign

### T155 Tripod

*For Roll-Up and Rigid Signs*

The T155 tripod is an all-purpose three legged heavy duty sign stand designed to hold 36" and 48" rigid signs. Roll-up signs can also be displayed with the addition of the optional roll-up sign adapter.

- Meets MUTCD specifications, NCHRP-350 compliant.
- Telescoping mast, flagholder for 3 standard flags.
- Displays 36" and 48" rigid signs, displays roll-up signs with the addition of optional #RUB100 roll-up sign adapter.
- Powder coated, rugged square tubular steel construction.



Add the optional RUB100 for roll up signs



T155 with 48" rigid sign

## DSB100 Stand

For Roll-Up Signs

The DSB100 Stacker™ sign stand displays both 36" and 48" roll-up signs. Made of rubber from recycled tires, the Stacker™ features a small foot print, compact storage, and several different models from which to choose.

- Meets MUTCD specifications, NCHRP-350 compliant.
- Low profile rubber base design is ideal for limited storage or display areas.
- Two molded handles allows for easy transport.
- DSB100 features a Latch style pocket sign holder for standard roll-up signs while the DSB100-W comes with the Screwlock™ universal roll-up sign holder.
- The HD models feature increased overall weight for added stability.



DSB100 stand with roll up sign



DSB100 W with ScrewLock sign holder



Stack of 4 DSB100 stands is only 12" tall!

Model Number	Sign Height*	Roll-Up Sign Holder Type	Weight
DSB100	12"	Latch	42 lbs.
DSB100-W	12"	Screwlock™	43 lbs.
DSB100HD	12"	Latch	48 lbs.
DSB100HD-W	12"	Screwlock™	49 lbs.

\*Ground to bottom of 48" sign

## Barrier Mounts

For Roll-Up and Rigid Signs



JBM Series



Barrier mount sign stands are designed to display 36" and 48" rigid and roll-up signs on concrete highway barriers. Units are firmly affixed using multiple heavy duty screws. All models feature aluminum masts with either rigid brackets or roll-up bracket depending on model and sign type. The JBM-TF18 series features a double spring system for added stability in windy conditions.



JRB Series



Model Number	Barrier Width	Sign Type	Stand Type
JBM-TF18-RU	6" to 12"	Roll-Up	Spring
JBM-TF18-RG	6" to 12"	Rigid	Spring
JBM-TF18-RG/RU	6" to 12"	Roll-Up & Rigid	Spring
JRB1A-RUB	7.5" to 15"	Roll-Up	No Spring
JRB1A-RGB	7.5" to 15"	Rigid	No Spring

## Fold & Roll Sign System

### For Construction and Maintenance

The 3000XP series Fold & Roll Sign System™ utilizes a collapsible leg and panel design for compact storage and ease of transport to and from the work zone. The need for separate storage locations for stand and sign is eliminated. The Dicke patented leg kick release and snap-in hub mechanism insures quick, hassle free set-up allowing crews to be more productive and safer.

- Meets MUTCD specifications, NCHRP-350 compliant.
- Sign panel detaches from stand for changeability of legends via the Stablock panel holder (see page 4)
- Stand features the Stablock™ sign holder (see page 4), telescoping legs with kick releases, and torsion spring system which reacts smoothly to gusty wind conditions.
- Fold & Roll™ signs also work with the UF2000S stand, see page 9.
- All systems include a double flagholder and two 18" vinyl flags.



Complete Fold & Roll™ Systems - 36"

Model Number	Sign Material	Stand Only	Sign Only
<b>DF3000X36</b>	Super Bright™ Reflective	DF3000S	3000XP-36
<b>DF3000X36MAR</b>	Marathon™ Reflective	DF3000S	3000XP-36MAR
<b>DF3000X36NR</b>	Solid Vinyl - Non- Reflective	DF3000S	3000XP-36NR
<b>DF3000X36M</b>	Mesh - Non- Reflective	DF3000S	3000XP-36M

Complete Fold & Roll™ Systems - 48"

Model Number	Sign Material	Stand Only	Sign Only
<b>DF3003X48</b>	Super Bright™ Reflective	DF3003S	3000XP-48
<b>DF3003X48MAR</b>	Marathon™ Reflective	DF3003S	3000XP-48MAR
<b>DF3003X48NR</b>	Solid Vinyl - Non- Reflective	DF3003S	3000XP-48NR
<b>DF3003X48M</b>	Mesh - Non-Reflective	DF3003S	3000XP-48M

Other Super Bright™ colors available in both sizes, please call for details

### Quick and Easy Set-Up

Using the patented Dicke kick release, quickly lock legs into place. Unwrap velcro strap releasing sign panel. Pull vertical support arm upward locking into place. Finish off set-up by locking horizontal ribs in place by pulling and snapping into hub. Reverse process for storage.

**DF3000X36** - 36" System - 21 lbs.

**DF3003X48** - 48" System - 24 lbs.



## Fold & Roll Sign System

### For Emergency Traffic Control

The Fold & Roll™ sign and stand combination brings ultra compact system storage and lightning fast deployment to emergency traffic control. Designed so that a full 48" sign and stand combo fits easily into the trunk of a squad car or a small storage compartment on a truck, the Fold & Roll™ sets up far faster than any other sign system in the industry allowing responders to concentrate fully on the task at hand.

Sign faces are made of fluorescent pink reflective material recommended by the FHWA and NFPA for use at emergency scenes.



**From stored..to deployed in 20 seconds!**

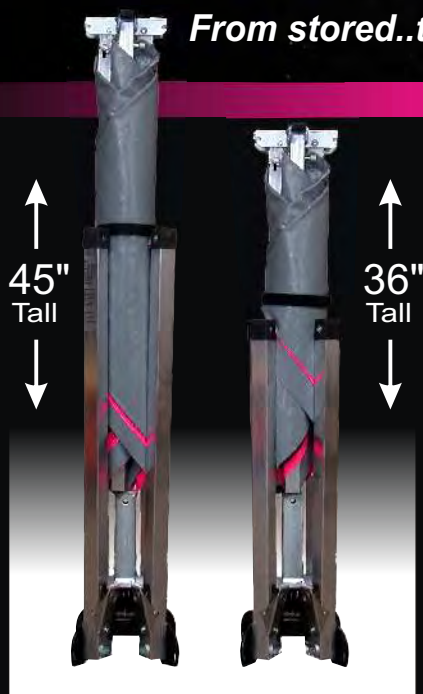

Storage Configuration

Complete Fold & Roll™ Systems - Pink			
Model Number	Sign Material	Stand Only	Sign Only
DF3000X36PNK	Super Bright™ Reflective	DF3000S	3000XP-36PNK
DF3003X48PNK	Super Bright™ Reflective	DF3003S	3000XP-48PNK

**FIRE  
ACCIDENT  
ROAD  
DETOUR  
CLOSED  
TRAINING**

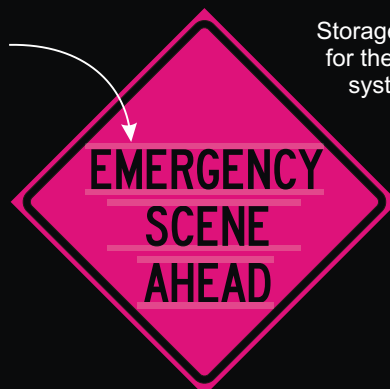

Storage bags are available for the Fold & Roll™ sign system, see page 29 for details



the original  
**FOLD & ROLL**

Signs become more versatile with the addition of velcro and overlays. For overlays for use with 36" signs, use part number FPO36PNK, for 48" signs use part number FPO48PNK. Specify message and position. Many other sign legend/overlay variations available on request.

## Features



## Materials and Specifications

Available in a variety of materials and sizes, roll-up signs offer full size signage in a lightweight and easy to store design.

- All roll-up stands are MUTCD and NCHRP-350 compliant.
- Fiberglass ribs, or cross bracing, feature a protective veil to prevent blooming and painful splinters.
- Corner pockets are made of tough polycarbonate for durability.
- Hook and loop strap for storage.
- Overlays for changeable message signs also available.

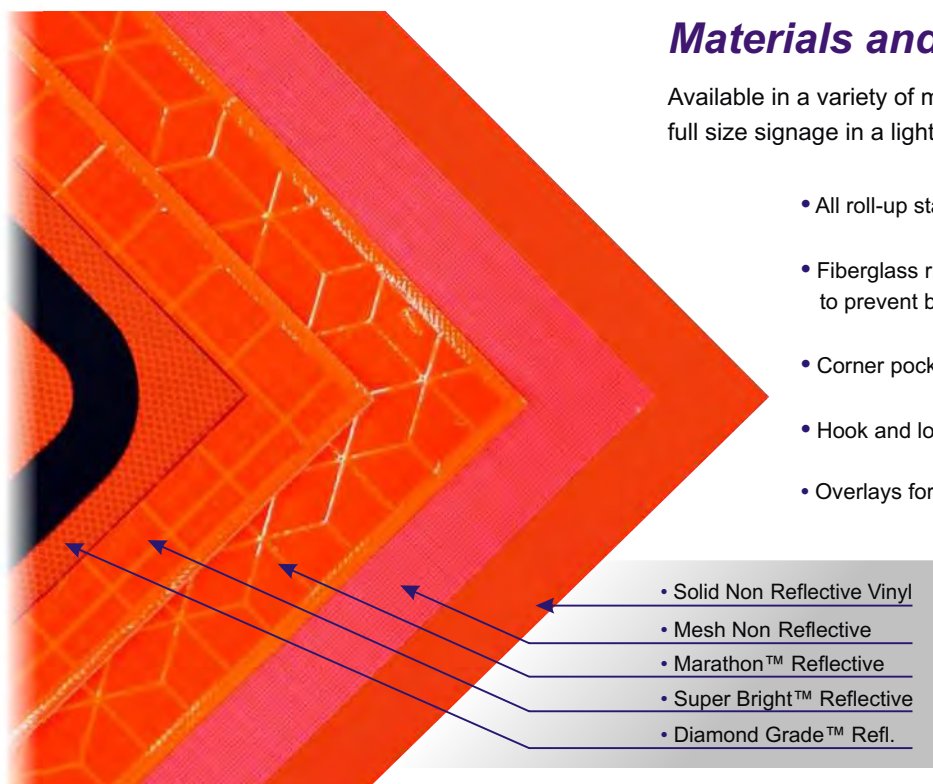

Other reflective Super Bright™ sign colors: Yellow, White, Lime, Pink

Legends in **bold orange** are 48" signs complete with fiberglass rib sets that are kept in stock for immediate shipping in both Super Bright™ reflective and solid non-reflective materials. Legends in **bold pink** are typically used for emergency traffic control situations. Sign legends may be printed on any reflective or non-reflective material. Custom legends are available for an additional temporary screen fee. Most legends may be equipped with velcro strips to allow overlays to be utilized. For example, ROAD WORK AHEAD may come with velcro for the word AHEAD so that a 1000 FT overlay can be applied. Ask for this option at time of order.

## ACCIDENT AHEAD

ACCIDENT AHEAD RIGHT LANE  
ACCIDENT DETOUR AHEAD  
ARROW LEFT 45°  
ARROW RIGHT 45°  
**BE PREPARED TO STOP**  
BEGIN MOWING ZONE  
BLASTING ZONE TURN OFF 2 WAY RADIO  
BORDER ONLY  
BRIDGE INSPECTION CREW  
BUMP AHEAD  
CAUTION HIGH WATER  
CAUTION LOG TRUCKS  
CAUTION PEDESTRIAN CROSSING SYMBOL  
CAUTION SMOKE OR FOG AHEAD  
COMMAND POST  
DETOUR AHEAD  
DIP

## EMERGENCY SCENE AHEAD

EMERGENCY TRUCK REPAIR AHEAD  
END MOWING ZONE  
END ROAD WORK  
END UTILITY WORK  
EQUIPMENT IN RIGHT LANE  
EXIT (WITH 45° UP RIGHT ARROW)  
EXIT CLOSED

## FIRE ACTIVITY AHEAD

**FIRE TRAINING AHEAD**  
FIRE TRAINING CENTER

## FLAGGER AHEAD

**FLAGGER SYMBOL**  
FLAGMAN AHEAD  
FRESH OIL  
FRESH OIL LOOSE GRAVEL  
FRESH TAR

GIVE US A BRAKE SLOW DOWN  
GUARDRAIL DAMAGE AHEAD  
HEAVY EQUIPMENT CROSSING  
HIGH WATER

## INCIDENT AHEAD

LANE CLOSED AHEAD  
LANE SHIFT LEFT ARROW (SYMBOL)  
LANE SHIFT RIGHT ARROW (SYMBOL)  
LEFT LANE CLOSED  
LEFT LANE CLOSED AHEAD  
LOW SHOULDER

## MEN WORKING

MERGE WITH LEFT ARROW  
MERGE WITH RIGHT ARROW  
MOWERS AHEAD  
MOWING AHEAD  
MOWING OPERATIONS AHEAD  
MOWING ZONE  
NO CENTER STRIPE

## ONE LANE ROAD AHEAD

POTHOLE REPAIR AHEAD  
POWER LINES WITH UP ARROW  
PREPARE FOR SUDDEN STOP  
PREPARE TO STOP  
PRESCRIBED BURN AHEAD  
PRESCRIBED BURN AHEAD DO NOT REPORT  
RAMP WORK AHEAD

## REDUCED SPEED AHEAD

RESUME SPEED THANK YOU  
**RIGHT LANE CLOSED**  
**RIGHT LANE CLOSED AHEAD**  
RIGHT TURN LANE CLOSED  
RIGHT TWO LANES CLOSED  
ROAD CLOSED  
**ROAD CLOSED AHEAD**  
ROAD FLOODED  
ROAD MACHINERY AHEAD  
**ROAD WORK AHEAD**  
ROAD WORK AHEAD FRESH OIL  
ROUGH ROAD  
SAFETY BELT ENFORCEMENT ZONE  
SAFETY RESTRAINT CHECKPOINT AHEAD  
SHOULDER CLOSED  
SHOULDER DROP OFF  
SHOULDER WORK  
SHOULDER WORK AHEAD  
SLIPPERY WHEN WET SYMBOL  
SLOW SOBRIETY CHECKPOINT AHEAD  
SOFT SHOULDER  
SPEED LIMIT XX  
SPRAYING OPERATIONS AHEAD  
STATE POLICE SAFETY CHECK  
STEEL PLATE IN ROADWAY  
STOP AHEAD

STOP SLOW SYMBOL (FULL STAFF)

STOP (OCTAGON)

SURVEY CREW

SURVEY CREW AHEAD

SWEEPER AHEAD

TELEPHONE WORKERS AHEAD

## TOW TRUCK AHEAD

## TRAFFIC EMERGENCY AHEAD

TRAFFIC FINES DOUBLE IN WORK ZONES

TRAFFIC FINES DOUBLED IN WORK ZONES

## TRAINING EXERCISE AHEAD

TRANSITION LEFT SYMBOL (NEW STYLE)

TRANSITION RIGHT SYMBOL (NEW STYLE)

TREE WORK AHEAD

TRUCK SCALES AHEAD

TRUCKS ENTERING

TRUCKS ENTERING AND LEAVING HWY.

TRUCKS ENTERING HIGHWAY

TRUCKS HAULING

UNEVEN LANES

UTILITY CONSTRUCTION AHEAD

## UTILITY WORK AHEAD

UTILITY WORKERS AHEAD

WATCH FOR SLOW TRAFFIC

WATCH FOR STOPPED TRAFFIC

WATCH FOR WATER ON ROAD

WATER OVER ROAD

WORK AREA AHEAD

WORK ZONE BEGINS (SQUARE)

## WORKER SYMBOL

WORKERS

WORKERS AHEAD

WORKERS ON ROADWAY

YIELD (TRIANGLE)

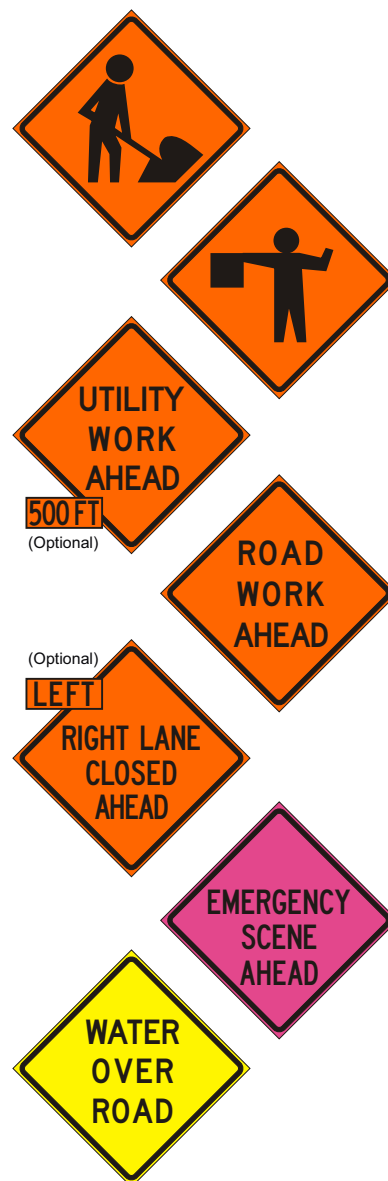

500 FT	1/2 MILE	RIGHT
1000 FT	1 MILE	LEFT
1500 FT	→	CENTER

Standard overlays attach to signs with velcro. Many other messages available on request

We have the ability to manufacture special shaped signs and custom legends to your specifications.

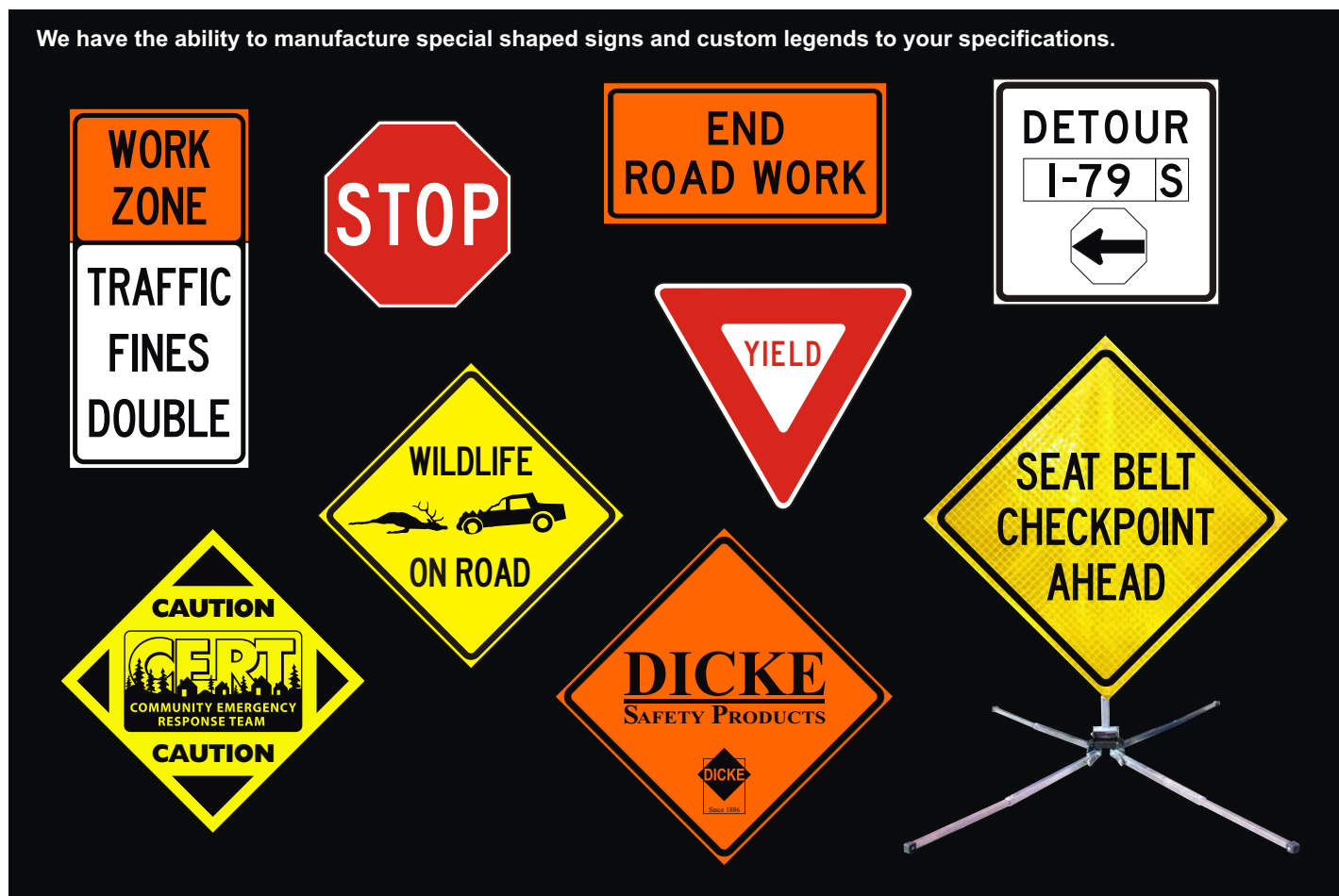

## Pedestrian Crossing Signs

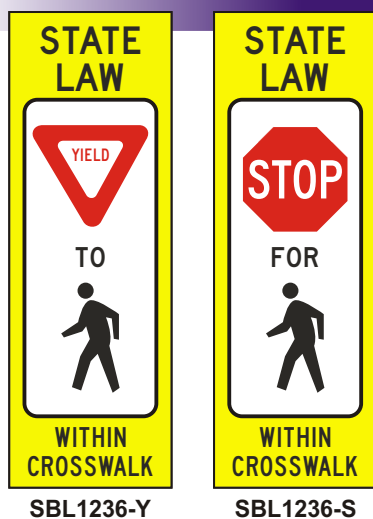

SBL1236-Y

SBL1236-S

Pedestrian crossing signs are used to remind drivers of laws regarding pedestrian right of way at unsignalized crossings. The "STOP FOR" legend is only intended to be used in states where the law specifically requires that drivers must stop for pedestrians in a crosswalk. Single or double sided.

Model Number	Type	Sign Faces
SBL1236-Y	Yield	Single
SBL1236D-Y	Yield	Double
SBL1236-S	Stop	Single
SBL1236D-S	Stop	Double



- Available in 12" x 36" lime Super Bright with white Super Bright retroreflective panel insert.
- Signs are fully assembled and feature fiberglass ribs and polycarbonate pocket for latch style sign holders.
- Stand options include the DSB100 STACKER™ Rubber Base Stand pictured above, see pg.13.



**Delta™ Pockets**

At 3/4" deep, the Delta Pocket is designed to be easier to deploy than conventional pockets. Made of tough polycarbonate, it features three rivet points for increased strength and is used on the horizontal corners only. Compact size and molded channel for the velcro strap allow for the smallest storage diameter in the industry.



**Rectangular Pockets**

Featuring a full depth design, rectangular pockets are typically used at the top and bottom of the sign. Made of tough polycarbonate, they will fit all pocket style sign holders. Two rivets are housed within the body of the pocket making them more durable than most other designs. These pockets may be installed on the horizontal corners if requested.



**MultiClamp (390-MC)**

A specially designed all zinc plated steel bracket allows roll-up signs to attach to many vertical masts, with square or round posts, in a variety of diameters. Bracket lays flat and is rolled up with the sign for storage. MultiClamp is available factory installed or as a retro fit.

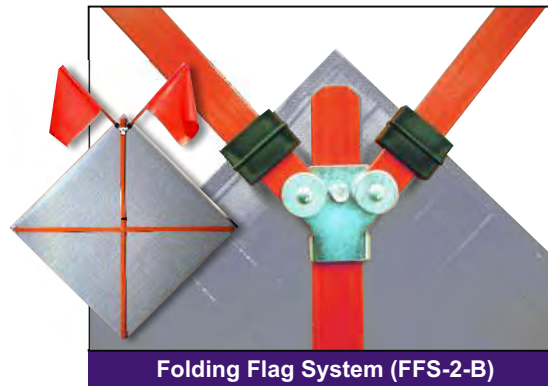

**Folding Flag System (FFS-2-B)**

The folding flag system allows permanent attachment of two 18" vinyl flags to roll-up signs. Flags roll up with the sign for storage and are always available for fast deployment. Sliding clips quickly lock flags in their open positions.

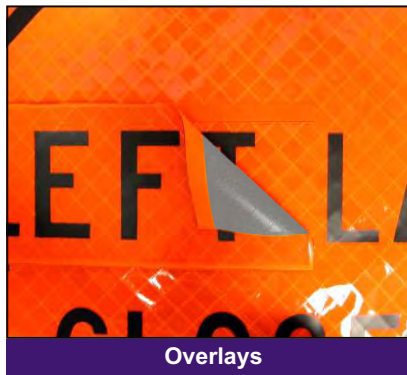

**Overlays**

Most signs may have velcro added to specific words that allows for multiple messages to be displayed using a single roll-up sign. Overlays are made from the same material as the sign and come with velcro strips on the back. Snap attachment is also available on request.



**Roll-Up Bracket (RUB3315)**

This bracket allows roll-up signs to be mounted to the vertical mast on full size sign stands. Horizontal fiberglass ribs, up to 1/4" thick, slide down locking the sign securely into bracket. A quick pull on the spring loaded catch releases the sign. Zinc plated steel bracket is held in place on the mast with "L" shaped screw handle which allows it to be height-adjustable. Stands with part numbers ending in RUB or RG/RU come with the RUB3315 installed, it may also be ordered as a separate item.

## Safety Vests - V1000

Low visibility is one of the most serious hazards facing workers today in construction work zones. ANSI/ISEA 107-2004 is a nationally recognized performance based standard for high-visibility apparel. By using an ANSI class garment the user maximizes their visibility to the motorist. The standard offers three classes of garments based on worker hazards, complexity of the work zone, vehicular traffic and speed considerations. ANSI Class II and Class III garments require 360 degree retro-reflectivity with specific criteria regarding width, placement and spacing of the tape, along with color brightness of the background material. In addition, Class III garments now require sleeves with reflective encircling the arm.



The **V1000** vest meets ANSI Class 2 standards and features solid polyester material with a five point tear away design, one size fits most adjustability, triple-trim reflective stripes, expandable radio pocket, pencil pocket, mic clip, message provision on the back, and hook and loop closure.



Adjustable side straps for a custom fit



Mic clip and pencil pocket



Silver Reflective Message Patch (optional)

Provision on Back for Optional Message Patch

V1000	
<b>Class</b>	2
<b>Material</b>	Solid Lime Polyester
<b>Stripes</b>	4" Orange with 2" Reflective Silver
<b>Features</b>	Size adjustable side straps, tear away design, pencil and expandable radio pockets, mic clip, message provision on back, hk. & loop closure
<b>Sizes</b>	Adjustable, One Size Fits Most

VP-SI	
<b>Material</b>	9" x 6" Silver Reflective Vinyl
<b>Features</b>	Hook and Loop Attachment

### Standard Vest Patch Messages:

Accountability, Air Supply, Ambulance, EMS, Fire, Fire Police, Fire Rescue, Incident Command, Information Officer, Interior Officer, Logistics, OEM, Operations, PIO, Police, Rehab, Rescue, Safety, Sheriff, Staging, Triage, Water Supply  
Custom messages available on request.



Public Safety Vests meeting ANSI 207-2006 are specially designed to provide unrestricted access to equipment, weapons, and medical devices that may be worn at the waist.

- Five point tear away – shoulders, sides and front.
- 360 degree visibility.
- Adjustable side straps for custom fit.
- Constructed of at least 450 square inches of background material and 201 square inches of retro-reflective tape.
- Tabs for mic or phone over upper chest on both sides.
- Provision for identification panel incorporated into the back side of the vest.
- **VP-SI** reflective I.D. panels sold separately. Standard and custom messages available.

VH710	
<b>Class</b>	2
<b>Material</b>	Mesh Lime Polyester
<b>Stripes</b>	2" Hi Gloss Reflective White/Blue
<b>Features</b>	Size adjustable side straps, tear away design, mic clips, message provision on back, hook & loop closure
<b>Sizes</b>	Adjustable, One Size Fits Most



Cool Mesh Material

## Class 2 - Public Safety Vests



VH700 and VH800 Meet Both ANSI 107-2004 and 207-2006 for Visibility



VH700	
<b>Class</b>	2
<b>Material</b>	Mesh Lime Polyester
<b>Stripes</b>	2" Hi Gloss Orange Reflective Stripes
<b>Features</b>	Size adjustable side straps, tear away design, 2 tabs for mic or phone message provision on back, hook and loop closure
<b>Sizes</b>	Adjustable, One Size Fits Most

Message Patches	
<b>VP-SI</b>	6" x 9" silver reflective message patch for VH710
<b>VP-OR</b>	4" x 8" orange reflective message patch for VH700
<b>VP-LI</b>	4" x 8" lime reflective message patch for VH800

**Standard Vest ID Patch Messages:**  
 Accountability, Air Supply, Ambulance, EMS, Fire, Fire Police, Fire Rescue, Incident Command, Information Officer, Interior Officer, Logistics, OEM, Operations, PIO, Police, Rehab, Rescue, Safety, Sheriff, Staging, Triage, Water Supply  
 Custom messages available on request.

VH800	
<b>Class</b>	2
<b>Material</b>	Mesh Orange Polyester
<b>Stripes</b>	2 Hi Gloss Lime Reflective Stripes
<b>Features</b>	Size adjustable side straps, tear away design, 2 tabs for mic or phone message provision on back, hook and loop closure
<b>Sizes</b>	Adjustable, One Size Fits Most

## Safety Vests - Triple Trim

### Class 2

These vests meet ANSI Class 2 standards with added visibility provided by our triple trim striping design consisting of 2" wide silver reflective stripes bordered on each side by 1" contrasting polyester trim.



V1100	
<b>Class</b>	2
<b>Material</b>	Solid Front, Mesh Back Lime
<b>Stripes</b>	4" Orange w/2" Refl. Silver
<b>Features</b>	Expandable radio pocket, pencil pocket, zipper pocket, large inner pocket, zipper closure
<b>Sizes</b>	Med. thru 5XL

V1200	
<b>Class</b>	2
<b>Material</b>	Solid Front, Mesh Back
<b>Stripes</b>	4" Lime w/2" Refl. Silver
<b>Features</b>	Expandable radio pocket, zipper pocket, large inner pocket, zipper closure
<b>Sizes</b>	Med. thru 5XL

V1300	
<b>Class</b>	2
<b>Material</b>	Mesh Lime Polyester
<b>Stripes</b>	4" Orange w/2" Refl. Silver
<b>Features</b>	Expandable radio pocket, pencil pocket, zipper pocket, large inner pocket, zipper closure
<b>Sizes</b>	Med. thru 5XL

V1400	
<b>Class</b>	2
<b>Material</b>	Mesh Orange Polyester
<b>Stripes</b>	4" Lime w/2" Reflective Silver
<b>Features</b>	Expandable radio pocket, pencil pocket, zipper pocket, large inner pocket, zipper closure
<b>Sizes</b>	Med. thru 5XL

### Class 3

These vests meet ANSI Class 3 standards for worker safety. V155 and V255 add our popular triple trim striping pattern for added visibility.



V155	
<b>Class</b>	3
<b>Material</b>	Mesh Lime Polyester
<b>Stripes</b>	4" Orange w/2" Refl. Silver
<b>Features</b>	Expandable radio pocket, pencil pocket, zipper pocket, large inner pocket, zipper closure
<b>Sizes</b>	Med. thru 5XL

V255	
<b>Class</b>	3
<b>Material</b>	Mesh Orange Polyester
<b>Stripes</b>	4" Lime w/2" Refl. Silver
<b>Features</b>	Expandable radio pocket, pencil pocket, zipper pocket, large inner pocket, zipper closure
<b>Sizes</b>	Med. thru 5XL

V150 (Lime) V250 (Orange)	
<b>Class</b>	3
<b>Material</b>	Mesh Lime or Orange Polyester
<b>Stripes</b>	2" Refl. Silver
<b>Features</b>	Pencil pocket, zipper pocket, zipper closure
<b>Sizes</b>	Med. thru 5XL

## Class 2



V30	
Class	2
Material	Lime Mesh Polyester
Stripes	2" Reflective Silver
Features	Hook and Loop Closure
Sizes	Med. thru 5XL

V30-2	
Class	2
Material	Lime Mesh Polyester
Stripes	2" Reflective Silver
Features	Hook and Loop Closure, 2 Horizontal Stripes for Visibility
Sizes	Med. thru 5XL

V31	
Class	2
Material	Lime Mesh Polyester
Stripes	2" Reflective Silver
Features	Zipper closure
Sizes	Med. thru 5XL

V31-2	
Class	2
Material	Lime Mesh Polyester
Stripes	2" Reflective Silver
Features	Zipper Closure, 2 Horizontal Stripes for Visibility
Sizes	Med. thru 5XL

## Class 2



V40	
Class	2
Material	Orange Mesh Polyester
Stripes	2" Reflective Silver
Features	Hook and Loop Closure
Sizes	Med. thru 5XL

V40-2	
Class	2
Material	Orange Mesh Polyester
Stripes	2" Reflective Silver
Features	Hook and Loop Closure, 2 Horizontal Stripes for Visibility
Sizes	Med. thru 5XL

V41	
Class	2
Material	Orange Mesh Polyester
Stripes	2" Reflective Silver
Features	Zipper Closure
Sizes	Med. thru 5XL

V41-2	
Class	2
Material	Orange Mesh Polyester
Stripes	2" Reflective Silver
Features	Zipper Closure, 2 Horizontal Stripes for Visibility
Sizes	Med. thru 5XL



## Class 2 5 Point Tear Away



### VB30

<b>Class</b>	2
<b>Material</b>	Lime Mesh Polyester
<b>Stripes</b>	2" Reflective Silver
<b>Features</b>	5 Point Tear Away Design, Hook and Loop Closure
<b>Sizes</b>	Med. thru 5XL



### VH402-2 (Orange) VH302-2 (Lime)

<b>Class</b>	2
<b>Material</b>	Lime or Orange Solid Polyester
<b>Stripes</b>	2" High Gloss Reflective
<b>Features</b>	Expandable Radio Pocket, Mic Clip, Outside Zipper Pocket, Large 5" x 7" Inner Pocket, Snap Closure
<b>Sizes</b>	Med. thru 5XL

## Class 2



### V100

<b>Class</b>	2
<b>Material</b>	Lime Mesh Polyester
<b>Stripes</b>	2" Refl. Silver
<b>Features</b>	Outside Zipper Pocket, Large 5" x 7" Inner Pocket, Hook and Loop Closure
<b>Sizes</b>	Med. thru 5XL

### V200

<b>Class</b>	2
<b>Material</b>	Orange Mesh Polyester
<b>Stripes</b>	2" Reflective Silver
<b>Features</b>	Outside Zipper Pocket, Large 5" x 7" Inner Pocket, Hook and Loop Closure
<b>Sizes</b>	Med. thru 5XL

### V300

<b>Class</b>	2
<b>Material</b>	Lime Solid Polyester
<b>Stripes</b>	2" Reflective Silver
<b>Features</b>	Outside Zipper Pocket, Large 5" x 7" Inner Pocket, Pencil Pocket, Zipper Closure
<b>Sizes</b>	Med. thru 5XL

### V400

<b>Class</b>	2
<b>Material</b>	Orange Solid Polyester
<b>Stripes</b>	2" Reflective Silver
<b>Features</b>	Outside Zipper Pocket, Large 5" x 7" Inner Pocket, Pencil Pocket, Zipper Closure
<b>Sizes</b>	Med. thru 5XL

## General Purpose Vests



V19	
<b>Material</b>	Mesh Lime Polyester
<b>Stripes</b>	None
<b>Sizes</b>	One Size Fits Most



V10	
<b>Material</b>	Mesh Lime Polyester
<b>Stripes</b>	2" Orange/Reflective Silver
<b>Sizes</b>	One Size Fits Most



V12	
<b>Material</b>	Mesh Lime Polyester
<b>Stripes</b>	1" Reflective White
<b>Sizes</b>	One Size Fits Most



V29	
<b>Material</b>	Mesh Orange Polyester
<b>Stripes</b>	None
<b>Sizes</b>	One Size Fits Most



V24	
<b>Material</b>	Mesh Orange Polyester
<b>Stripes</b>	2" Lime/Reflective Silver
<b>Sizes</b>	One Size Fits Most



V20	
<b>Material</b>	Mesh Orange Polyester
<b>Stripes</b>	3/4" Reflective Lime
<b>Sizes</b>	One Size Fits Most



V22	
<b>Material</b>	Mesh Orange Polyester
<b>Stripes</b>	2" Reflective Lime
<b>Sizes</b>	One Size Fits Most

## Vest Index

Model	Style	Color	Material	Page
V10	GP	Lime	Mesh	25
V12	GP	Lime	Mesh	25
V19	GP	Lime	Mesh	25
V20	GP	Orange	Mesh	25
V22	GP	Orange	Mesh	25
V24	GP	Orange	Mesh	25
V29	GP	Orange	Mesh	25
V30	ANSI 2	Lime	Mesh	25
VB30	ANSI 2	Lime	Mesh	24
V30-2	ANSI 2	Lime	Mesh	23
V31	ANSI 2	Lime	Mesh	23
V31-2	ANSI 2	Lime	Mesh	23
V40	ANSI 2	Orange	Mesh	23
V40-2	ANSI 2	Orange	Mesh	23
V41	ANSI 2	Orange	Mesh	23
V41-2	ANSI 2	Orange	Mesh	23

Model	Style	Color	Material	Page
V100	ANSI 2	Lime	Mesh	24
V150	ANSI 3	Lime	Mesh	22
V155	ANSI 3	Lime	Mesh	22
V200	ANSI 2	Orange	Mesh	24
V250	ANSI 3	Orange	Mesh	22
V255	ANSI 3	Orange	Mesh	22
V300	ANSI 2	Lime	Solid	24
V400	ANSI 2	Orange	Solid	24
V1000	ANSI 2	Lime	Solid	20
V1100	ANSI 2	Lime	Combo	22
V1200	ANSI 2	Orange	Combo	22
V1300	ANSI 2	Lime	Mesh	22
V1400	ANSI 2	Orange	Mesh	22
VH302-2	ANSI 2	Lime	Solid	24
VH402-2	ANSI 2	Orange	Solid	24
VH700	ANSI 2	Lime	Mesh	21
VH800	ANSI 2	Orange	Mesh	21



### Class E Pants

- ANSI 107-2004 compliant Class E pants.
- ANSI Class III compliant when worn with Dicke Class II vests, t-shirts, or jackets.
- Drawstring waist with elastic.
- Pass through side pockets.
- Adjustable pant leg opening with heavy duty snaps for tight fit.
- Popular 4" triple trim reflective stripes.
- **P1100** and **P1200** feature washable polyester and combine a solid top half with a mesh bottom for added strength and comfort.
- **P1500** is constructed of water resistant polyurethane fabric.

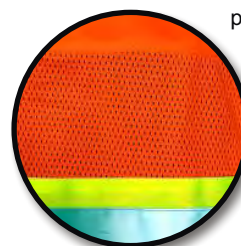

Solid top/mesh bottom  
(P1100 & P1200)

P1100	
<b>Class</b>	E
<b>Material</b>	Lime Mesh/Solid Polyester
<b>Stripes</b>	4" Orange With 2" Refl. Silver
<b>Sizes</b>	M/L, XL/2XL, 3XL/4XL

P1500	
<b>Class</b>	E
<b>Material</b>	Lime/Blue Polyurethane
<b>Stripes</b>	2" Reflective Silver
<b>Sizes</b>	M/L, XL/2XL, 3XL/4XL

P1200	
<b>Class</b>	E
<b>Material</b>	Orange Mesh/Solid Polyester
<b>Stripes</b>	4" Lime With 2" Refl. Silver
<b>Sizes</b>	M/L, XL/2XL, 3XL/4XL

## T-Shirts



T-shirts are made from comfortable wicking polyester material and are available in both orange and lime colors. T-shirts with stripes meet ANSI Class 2 specifications. All shirts have a front left breast pocket and are available in sizes small through 5XL.

TS29	
<b>Material</b>	Orange Polyester
<b>Stripes</b>	None

TS19	
<b>Material</b>	Lime Polyester
<b>Stripes</b>	None

TS200	
<b>Class</b>	2
<b>Material</b>	Orange Polyester
<b>Stripes</b>	2" Reflective Silver

TS100	
<b>Class</b>	2
<b>Material</b>	Lime Polyester
<b>Stripes</b>	2" Reflective Silver





All parkas and jackets feature drawstring hoods that store in collar



## Bomber Jackets

- Jackets meet ANSI 107-2004 Class 3 standards.
- Dual orange/lime color to maximize visibility.
- Weather resistant polyurethane coated fabric.
- Zip-out, drawstring hood.
- Fleece lined front pockets.
- Radio pocket, pencil pocket on sleeve.
- 2" silver stripes on jacket and liner.



**J4211** and **JH4211** feature a removable polar fleece liner with 2" reflective stripes

## Parka (J5200)

- Meets ANSI 107-2004 Class 3 requirements.
- Hi-viz orange and lime over blue maximizes visibility.
- 2" wide reflective silver stripes.
- Weather resistant polyurethane coated fabric.
- Quilted inside liner, zip-out, drawstring hood.
- Expandable outside breast pocket.
- Two large outside pockets have top flaps with hook and loop closure.
- Two large inside pockets and inside pencil pocket.
- Drawstring bottom cinches tight for warmth.
- Sizes: Medium through 5XL



Removable Fleece Liner

J3201	
<b>Class</b>	3
<b>Material</b>	Polyurethane coated polyester
<b>Stripes</b>	2" Reflective Silver
<b>Features</b>	Permanent liner, zip out drawstring hood, fleece lined front pockets, radio pocket on sleeve, inside breast pocket
<b>Sizes</b>	Medium through 5XL

J4211	
<b>Class</b>	3
<b>Material</b>	Polyurethane Coated Polyester
<b>Stripes</b>	2" Reflective Silver
<b>Features</b>	Removable lime polar fleece liner with reflective stripes, zip out drawstring hood, fleece lined front pockets, radio pocket on sleeve, inside breast pocket
<b>Sizes</b>	Medium through 5XL

JH4211	
<b>Class</b>	3
<b>Material</b>	Polyurethane Coated Polyester
<b>Stripes</b>	2" High Gloss Reflective Lime
<b>Features</b>	Removable lime polar fleece liner with reflective stripes, zip out drawstring hood, fleece lined front pockets, radio pocket on sleeve, inside breast pocket
<b>Sizes</b>	Medium through 5XL

### Vest and Jacket Customizing

With several methods to choose from, customize your safety vests, t-shirts and jackets with company logo and/or name, or message. Please call for more information.

- Silk Screen - Black Ink
- Heat Transfer – Multi Colors
- Reflective Heat Transfer – Silver 3M Scotchlite



Multi Color Heat Transfer



Silk Screen Black

### Custom Trade Show Banners



Custom banners for trade shows and special functions are now available! Printed to your specifications in full color on thick white vinyl banner material and in a variety of sizes up to 4' x 10', these banners can be used over and over again. We can also add grommets for rope or bungee attachment on request. Please call for more information.



Roll-Up Signs & Stands



1201 Warren Ave.  
Downers Grove, IL 60515  
Tel: 630-969-0050  
Fax: 630-969-3973

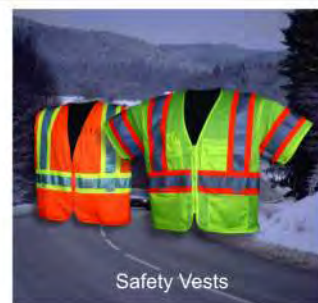

Safety Vests

## Flags



18" and 24" mesh and solid vinyl flags, blaze orange color, are available with or without 3/4" round wood staffs. Mesh flags have cloth binding.

Model Number	Flag Size	Flag Material	Feature
1024-18	18"	Vinyl	24" Wood Staff
1030-18	18"	Vinyl	30" Wood Staff
1036-24	24"	Vinyl	36" Wood Staff
1010-18	18"	Vinyl	No Staff
1010-18W	18"	Vinyl	Tailgate Flag, Wire Loop
1024-18M	18"	Mesh	24" Wood Staff
1030-18M	18"	Mesh	30" Wood Staff
1036-18M	18"	Mesh	36" Wood Staff
1036-24M	24"	Mesh	36" Wood Staff
1010-18M	18"	Mesh	No Staff
1010-18MW	18"	Mesh	Tailgate Flag, Wire Loop



Stop Flag, model number **1830P-18S** is 18" x 18" nylon flag with "STOP" printed on both sides. Featuring 1-1/2" lime/silver reflective stripes and 3/4"x 30" long pvc staff.

## Equipment Bags



### Sign System Bags

Designed to hold signs and stands, these bags are made of heavy duty vinyl and come with a webbing shoulder strap and zipper closure.

**B36** - Holds 2 - 36" signs and 2 compact stands

**B48** - Holds 2 - 48" signs and 2 compact stands

**B48SS** - Holds 1 - 48" sign and 1 Dynalite™ stand

**BFR36** - Holds 1 - 36" Fold & Roll™ system (p.14)

**BFR48** - Holds 1 - 48" Fold & Roll™ system (p.14)



### Roll-Up Sign Bags

Protective bags for one roll-up sign. Made of heavy duty vinyl with a hook and loop closure.

**B36SO** - Holds 1 - 36" roll-up sign

**B48SO** - Holds 1 - 48" roll-up sign



### Equipment Bags

Vinyl bags come with strap, zipper closure, and inside pocket.

**BE24** - 24" long equipment bag

**BE36** - 36" long equipment bag

## Oversize Load Banners



Banners are available in reflective orange Super Bright™ or yellow non-reflective vinyl with grommets in each corner.

**B5ONR** - 60" x 12" yellow, non-reflective

**B7ONR** - 84" x 18" yellow, non-reflective

**B7OSB** - 84" x 18" orange, reflective

## Pennants



Plastic pennants, 8" wide x 12" long spaced at 8-1/2", come attached to a 60' or 100' braided cord.

**PLM-60** - 60' Multicolor Pennants

**PLM-100** - 100' Multicolor Pennants

**PLR-60** - 60' Red Pennants

## Roll-Up Stop/Slow Kits

Roll-Up stop/slow paddles offer full size paddles in a compact, lightweight, and easy to store design. Available in 18" and 24" octagons and in a variety of reflective and non-reflective materials, these kits come complete with double sided roll-up sign face, three piece handle, and storage bag.

- Meets all MUTCD specifications.
- Available in reflective (Super Bright™, Diamond Grade™, Marathon™) or non-reflective vinyl.
- Your choice of 18" or 24" octagon.
- Comes with our new ABS plastic 3-piece handle, see below right.
- Kit comes with sign face, handle sections, and protective storage bag.



Model Number	Octagon Size	Sign Material
NR183A	18"	Non-Reflective Vinyl
NR243A	24"	Non-Reflective Vinyl
SB183A	18"	Reflective Superbright™
SB243A	24"	Reflective Superbright™
DG183A	18"	Reflective Diamond Grade™
DG243A	24"	Reflective Diamond Grade™
MR183A	18"	Reflective Marathon™
MR243A	24"	Reflective Marathon™

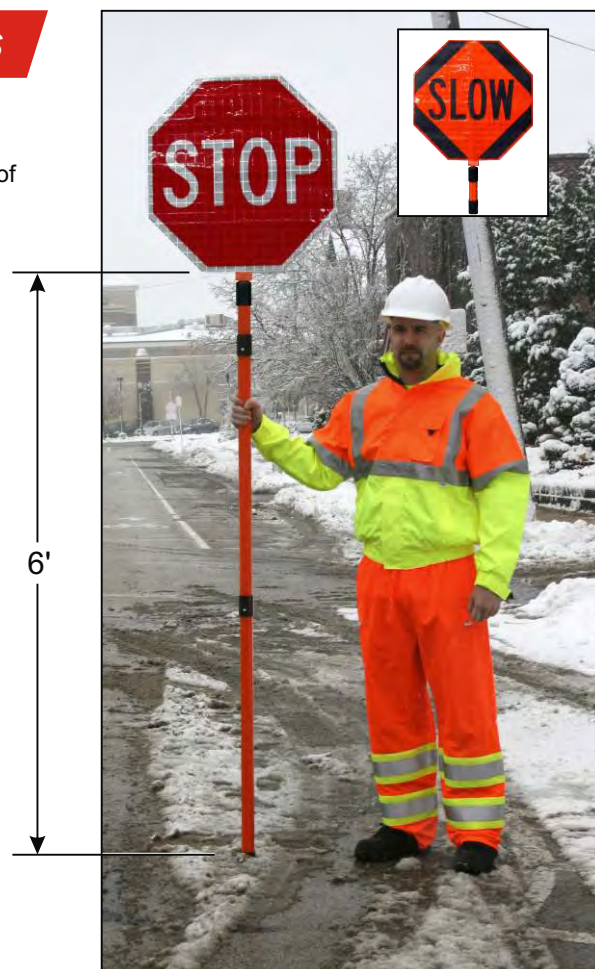

SB243 roll up stop / slow paddle  
Bomber jackets, page 27, pants page 26

## New Stop/Slow Handle!!



Our new stop/slow handle is designed for durability and ease of use. Heavy duty ABS plastic tube and socket connectors with locking spring buttons make deployment and take-down a snap. Handles feature flat facets front and back which aid the user in determining the sign's orientation, minimizing the amount of time their attention is away from traffic. A thick rounded bottom cap protects the handle from wear while making the unit easy to rotate.

Handle comes standard with our roll-up stop/slow kits and will be available in mid- 2009 for rigid models.

## Rigid Stop/Slow Paddles

Rigid stop/slow paddles are available in both 18" and 24" octagon versions with reflective and non-reflective surfaces. Choose either plastic or aluminum substrates. All rigid stop/slow paddles come with a 12" pvc handle attached, add our P52 (extension handle) to raise the sign to 6 feet off the ground.

- Meets all MUTCD specifications.
- STOP/STOP versions available in 18" non-reflective and engineer grade non-reflective.
- Your choice of 18" or 24" octagon.

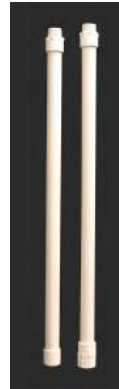

P52



A24HI Stop/Slow Paddle

Rigid Stop/Slow - Plastic		
Model Number	Octagon Size	Sign Material
P18NR	18"	Non-Reflective
P18NR-ST/ST	18"	Non-Reflective
P24NR	24"	Non-Reflective
P18EG	18"	Engineering Grade Reflective
P18EG-ST/ST	18"	Engineering Grade Reflective
P24EG	24"	Engineering Grade Reflective
P18HI	18"	High Intensity Reflective
P24HI	24"	High Intensity Reflective
P18DG	18"	Diamond Grade™ Reflective
P24DG	24"	Diamond Grade™ Reflective

Rigid Stop/Slow - Aluminum		
Model Number	Octagon Size	Sign Material
A18EG	18"	Engineering Grade Reflective
A24EG	24"	Engineering Grade Reflective
A18HI	18"	High Intensity Reflective
A24HI	24"	High Intensity Reflective
A18DG	18"	Diamond Grade™ Reflective
A24DG	24"	Diamond Grade™ Reflective

Extension Handle	
P52	Two Piece Plastic Handle For 7' Height
P61	One Piece Plastic Handle For 7' Height

## Economy Stop/Slow Paddles

**New** 18" octagon shaped stop/slow paddles are ultra lightweight and economical. Made from corrugated coroplast plastic panels, they come with an 8" plastic handle and fasteners for quick screwdriver assembly. The C18NR is available in non-reflective STOP/SLOW and STOP/STOP versions, add a 5' or 6' pvc plastic handle for extra height. Handles are slotted at the top to engage the paddle preventing spinning and keeping the sign face properly oriented to traffic.



STOP/STOP also available

Model Number	Octagon Size	Type
C18NR	18"	Non-Reflective STOP/SLOW
C18NR-ST/ST	18"	Non-Reflective STOP/STOP

### Economy Paddle Handles

PVC60	60" Long
PVC72	72" Long

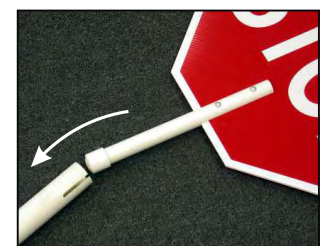

C18NR comes with 8" handle and slides into extension handles for added height

## AC4D D-Cell

The AC4D barricade light combines an LED light source and 3-volt photocell technology with the popular "D" cell battery. Extra light intensity is achieved via a computer designed, high clarity, polycarbonate lens. Three modes are available on the AC4D - flash, steady, and off. Changing from a flashing type "A" to a steady burn type "C" and back again is simple with push on the easy to locate mode switch. Meets the May 2001 ITE purchase specification. Hardware included in each box of 10 lights: 10 - 3-3/4" bolts, 2 - on/off keys, and 1 wrench.



- AC4D** - Yellow Body
- AC4D-BK** - Black Body
- AC4D-GR** - Green Body
- AC4D-BL** - Blue Body
- AC4D-OR** - Orange Body



## TrafiLITE™

The TrafiLITE™ features an incandescent bulb powered by a six volt lantern battery (not included). Offered in a flashing type "A" model, steady burn type "C", or in a combination "A" and "C" version. A finger loop on the circuit housing makes removing circuits from the upper case easy. TrafiLITE™ meets the May 2001 ITE purchase specification and is also available with a red lens. 10 - 3-3/4" bolts, 2 - on/off keys, and 1 wrench are included with each box of 10 lights.

- TLW2S** - 6V Steady Burn w/Photocell
- TLW6S** - 6V Flashing w/Photocell
- TLW8S** - 6V 3-Way (Flash/Steady/Off)



## Trafi-B-LITE™ - High Intensity LED

Powered by two six volt lantern batteries (not included), the Trafi-B-LITE™ provides outstanding daylight performance from a single high intensity LED operating at 6 volts. the on/off switch is covered by a rubber membrane to facilitate simple, rapid operation. Trafi-B-LITE meets the May 2001 ITE Purchase Specification and MUTCD visibility requirements for type "B" warning lights.

- BSL6N** - High Intensity Flashing

## UniLamp™

UniLamp™ features a 360°, computer designed, high clarity polycarbonate lens. Two versions are available, flashing and flashing with photocell. The yellow case is made of high impact polyethelene and comes with an integrated cone mounting bracket. UniLamp™ is powered by a 6 volt lantern battery (not included) and is also available with a red lens.

- UCW6N** - 6V Flashing
- UCW6S** - 6V Flashing w/Photocell



## Work Zone Safety

Help protect workers from construction work zone hazards. With continual traffic congestion, frustrated drivers, and deteriorating infrastructure, roadway work zone accidents have soared to an all-time high. There are solutions - insure that the right information is communicated and made available to each roadway worker exposed to danger. Positively guide motorist through work zones with proper equipment and placement. Bring work zones into compliance with Federal and State DOT requirements and OSHA standards.

### Temporary Traffic Control Pocket Reference Guide - PRG3A

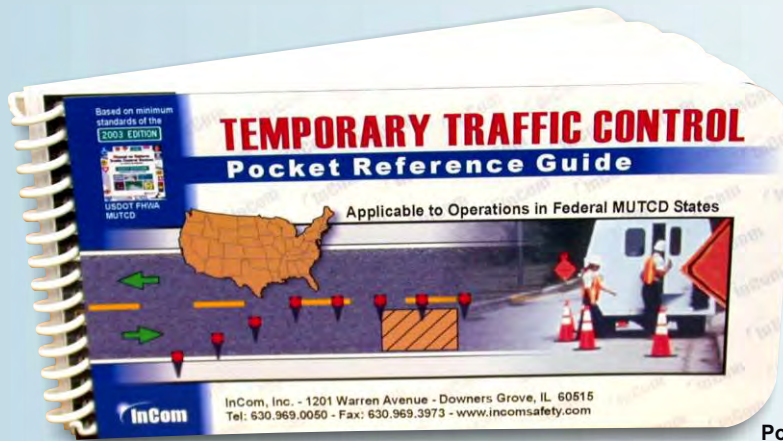

**BASED ON  
THE CURRENT  
MUTCD EDITION**

Pocket size: 3-5/8" x 7"

#### Economical Job Aid for Technicians.

- Based on the current Federal MUTCD.
- Thick, laminated, "field durable" pages.
- Quick reference charts and tables.
- Quick reference typical work zone drawings.
- Easy to use and easy application to roadways.

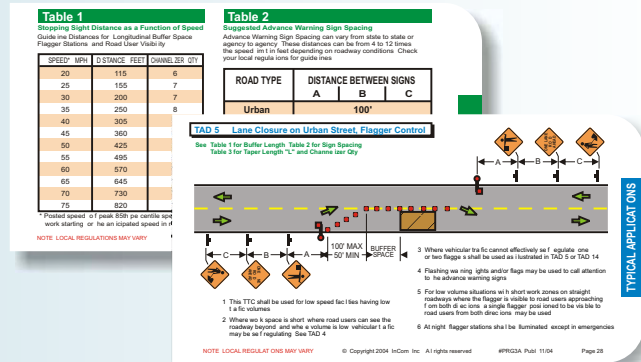

Typical Applications, Quick Reference Charts and Indexes

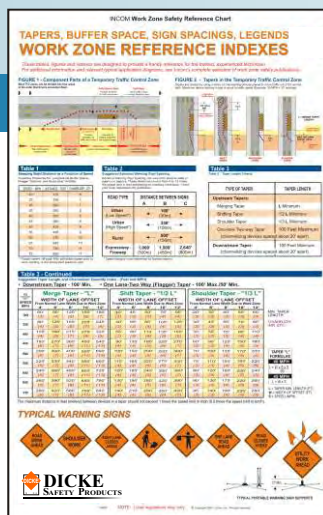

TD205

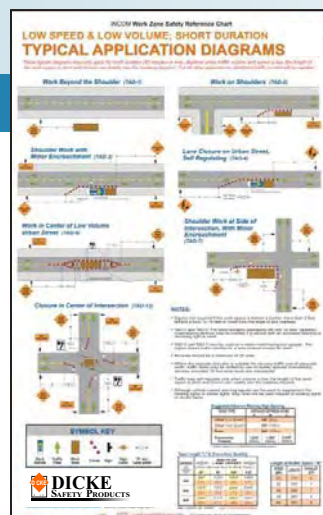

TD210

### Self-Adhesive Truck Posters

- Based on the latest federal MUTCD.
- Large format - 11" x 17", peel & stick adhesive backed.
- Addresses a variety of roadway work zones.

TD205 - Work Zone Reference  
TD210 - Short Duration Typicals

**Handy Truck Door  
Work Zone Safety Reminders**



- Meets OSHA requirements for ladder safety.
- Independent laboratory tested.
- Specially woven military specification canvas material with mildew inhibitors and wear indicator thread imbedded in the webbing.
- Reliable military specification hardware.
- Procedures for use are available at [www.dicketool.com](http://www.dicketool.com).

## Laddermate™

### LM100 Bottom Strap

Laddermate™ is a unique ladder safety product specifically designed to stabilize a straight or extension ladder when used on a utility pole (or other cylindrical object such as a light pole, piling, I-beam post, etc.). When properly used, Laddermate™ effectively eliminates the destabilizing "twisting" motion most responsible for ladder-on-pole mishaps. Because Laddermate™ is so quick and easy to use, it makes elaborate, time-consuming rope lash methods obsolete.

The first telephone operating companies to fully implement Laddermate™ over ten years ago found that ladder related accidents dropped sixty percent!



### LM200 Top Strap



The Laddermate™ top strap provides an extra level of safety and stability when used with the LM100. LM200 quickly secures the top of the ladder to a pole or strand.

- Meets OSHA requirements for ladder safety, laboratory tested.
- Special red nylon webbing material.
- Reliable military specification hardware.
- Procedures for use are available at [www.dicketool.com](http://www.dicketool.com).



### Laddermate™ Bag

Heavy duty mesh bag stores and protects straps. Zipper closure.

**LMB** - Bag only  
**LMBH** - Bag with hook



### Ladder Leveling Wedge

Durable hardwood construction, painted finish. Hardened steel feet provide non-slip footing on slippery or uneven terrain.

**8889** - Ladder leveling wedge

## Fiberglass Pruner Sections

Heavy duty fiberglass tubing make these handles the strongest, lightest, and most durable professional pruner handles available. Fiberglass affords many times the service life of wood handles, making them the best value for the professional user. The seamless aluminum ferrules mate with all standard attachments and can be used together with standard 1 1/4" diameter wood handles. Special surface treatment prevents "blooming" of glass fibers if dented. Safety yellow color.



- 820** - Fiberglass Extension Section - 1 1/4" x 6'
- 830** - Fiberglass Extension Section - 1 1/4" x 3'



## Wood Pruner Sections

Octagon shaped wood handles are fitted with interlocking seamless aluminum ferrules. Handles are provided in various lengths and configurations to fit virtually any task. Both extension sections and handles are 1 1/4" diameter and mate with fiberglass sections. Long handles are one piece with one end tapered for head. Many accessories available.

- 802A** - Head Section - 1 1/4" x 2'
- 802B** - 802 Head section w/ 812A Saw
- 803A** - Head Section - 1 1/4" x 6'
- 804** - Extension Section - 1 1/4" x 6'
- 840** - 12' Pruner Handle - 1 1/4" x 12'
- 844** - 14' Pruner Handle - 1 1/4" x 14'
- 845** - 16' Pruner Handle - 1 1/4" x 16'



**820 and 804**  
Extension Sections

## Pruner Heads, Adapters, and Saws



**812A** Saw Head

- 812A** - Saw Head with Saw Blade
- 812C** - Saw Blade only
- 815** - Wire Raising Tool (fits 804, 820, 830)
- 835** - Head Adapter (fiberglass handles)
- 851** - 10" Tapered Head Adapter w/male ferrule
- 852** - 10" Straight Head Adapter w/male ferrule



**815** Wire Raising Tool

## Cone Holders



All steel construction. Bolts on to work vehicles.

- CH150** - Holds 18" & 28" cones
- CH300** - Holds 36" cones



## DICKE SAFETY PRODUCTS

### **Illinois**

1201 Warren Avenue  
Downers Grove, IL 60515  
Ph: 877.891.0050 Toll Free  
Fax: 630.969.3973

### **Oregon**

1845 Anunsen Street, N.E.  
Salem, OR 97301  
Ph: 800.333.5641 Toll Free  
Fax: 503.364.0340

[www.dicketool.com](http://www.dicketool.com)